



### Technical details

Product No.	A41K24120Axx	A41K24160Axx	A41K24200Axx	A41K24240Axx
Led Q.ty (LEDs/m)	120	160	200	240
Led Type	2835	2835	2835	2835
Power (W/M)	4,8	9,6	16,80	22
Voltage (V)	24 ±3%	24 ±3%	24 ±3%	24 ±3%
Current (mA/M)	200	400	700	916
CRI (Ra)	≥ 90	≥ 90	≥ 90	≥ 90
Lenght/Reel (M)	5	5	5	4
Beam	120°	120°	120°	120°
Water-proof rating	IP65	IP65	IP65	IP65

Non-directional or directional light source:	Non-directional (NDLS)
Mains or non-mains light source:	Non-mains (NMLS)
Dimmable:	Only with specific LED drivers
Cables type:	PVC 80°C 20AWG lenght 36cm (double ended)
Pcb material:	COPPER
Tape type:	3M 9080
Energy rating:	E (EU 2019/2015) *
Protection against electric shock:	Class III
Version:	Integral
Safety isolating:	See electronic controlgear
Lumen maintenance factor:	96%
Survival factor:	100%
Nominal lifetime LM-80:	L70 B50 >54000 h
Photobiological Safety (Blue light hazard) according to IEC TR 62778:	Risk Exempt (RG0 group)

\*Energy class is calculated according to Spectrum test measurements

## LED STRIPS – 24V - LED 2835 – CRI90 – IP65 – K SERIE

### Lumens per meter

Color Temperature	A41K24120Axx	A41K24160Axx	A41K24200Axx	A41K24240Axx
2700K	580 lm	1210 lm	2110 lm	2720 lm
3000K	600 lm	1270 lm	2180 lm	2880 lm
4000K	640 lm	1340 lm	2350 lm	3060 lm

• Due to tolerances of the production process and the electrical components, values for light output and electrical power can vary up to 10%.

### Efficacy

Color Temperature	A41K24120Axx	A41K24160Axx	A41K24200Axx	A41K24240Axx
2700K	121 lmW	126 lmW	125 lmW	124 lmW
3000K	125 lmW	132 lmW	130 lmW	131 lmW
4000K	133 lmW	139 lmW	140 lmW	139 lmW

• Note: "xx"= CCT "27"(2700K)/"30"(3000K)/"40"(4000K)

### Light distribution

LUMINOUS INTENSITY DISTRIBUTION DIAGRAM

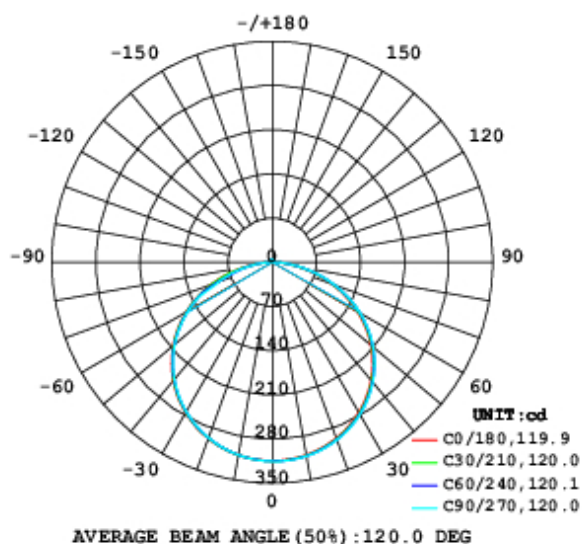

C0 PLANE ISOLUX DIAGRAM (UNIT:lx)

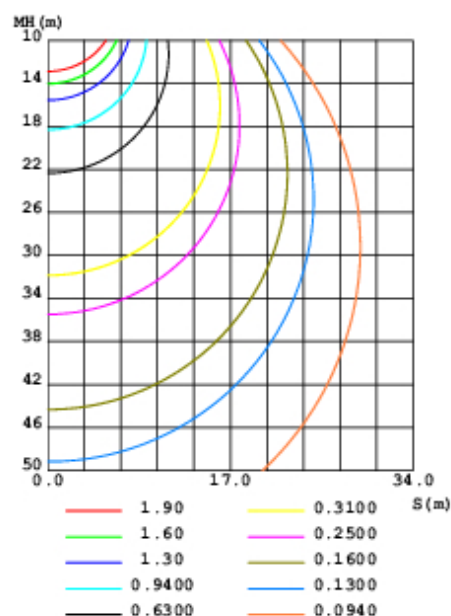

### Working conditions

Working Temperature (°C)	-20 ÷ 50
Storage Temperature (°C)	-30 ÷ 80
Voltage Range (Vdc)	23 ÷ 24
Reverse Voltage (Vdc)	24
Reference temperature (Tc)	80° C

# LED STRIPS – 24V - LED 2835 – CRI90 – IP65 – K SERIE

## Product dimensions

### 120LEDs/m

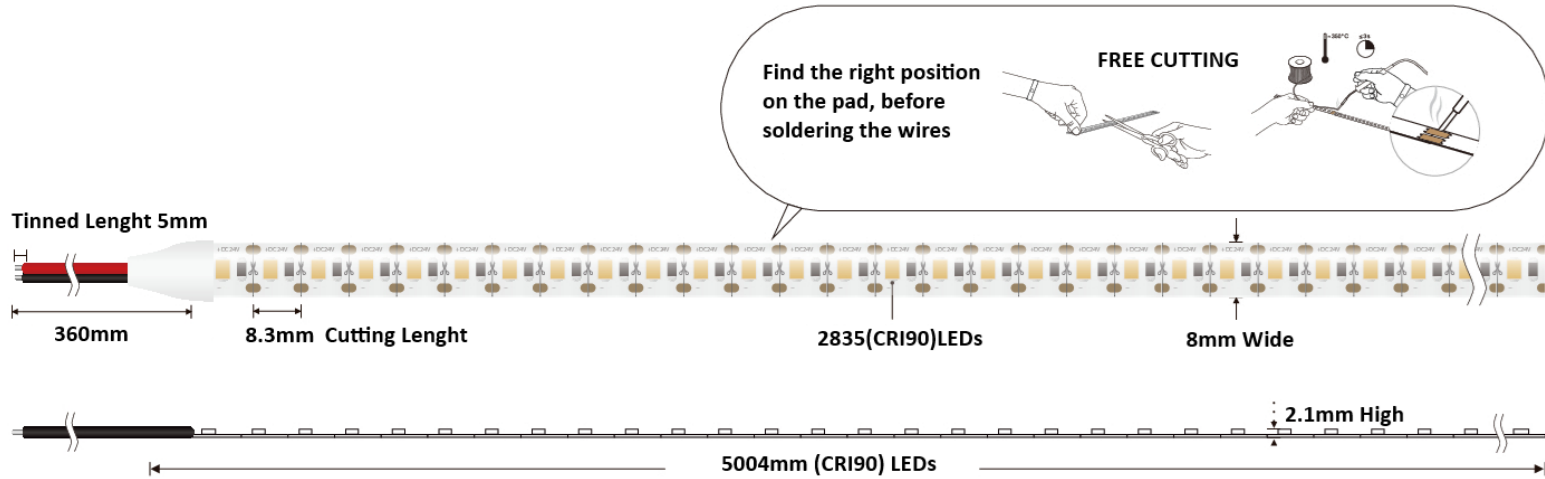

### 160LEDs/m

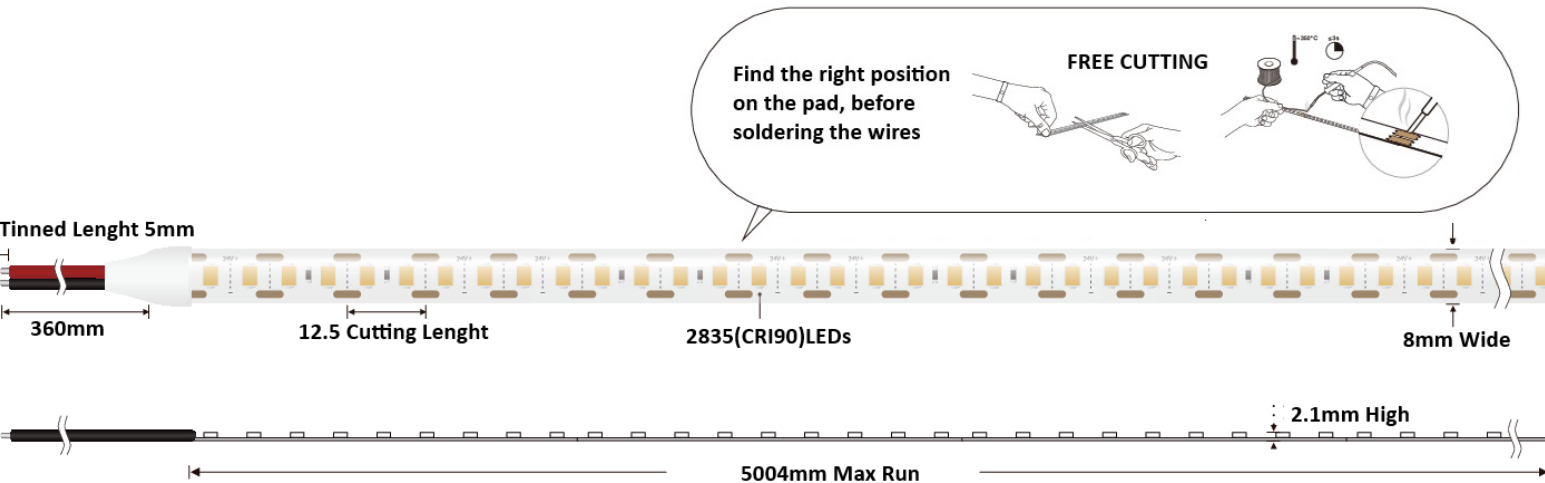

# LED STRIPS – 24V - LED 2835 – CRI90 – IP65 – K SERIE

## 200LEDs/m

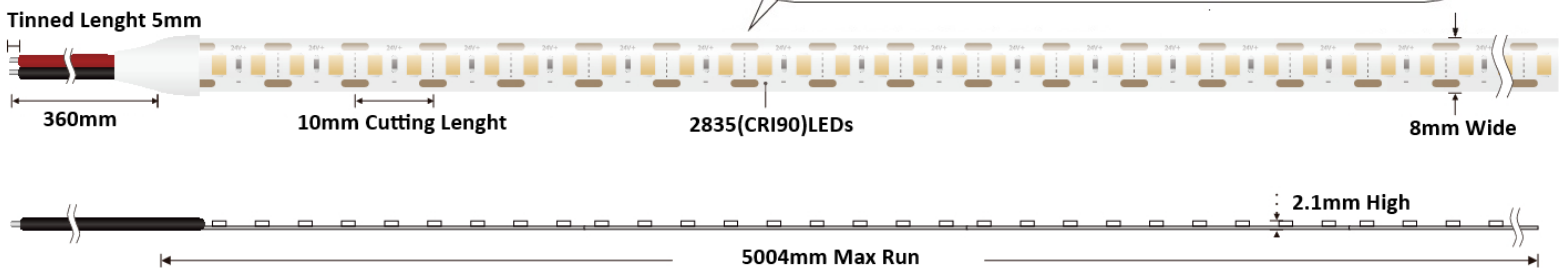
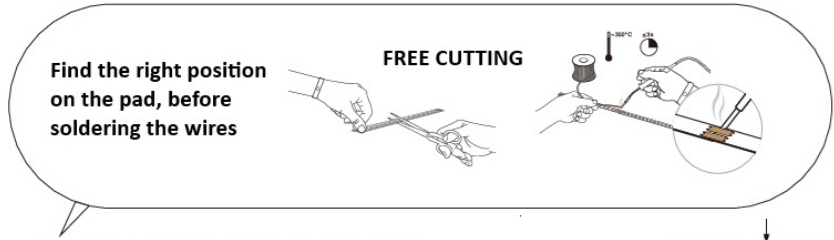

## 240LEDs/m

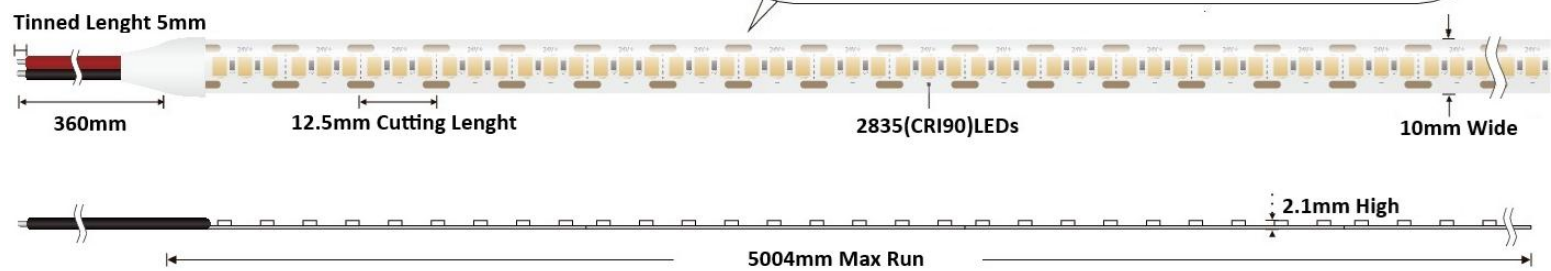
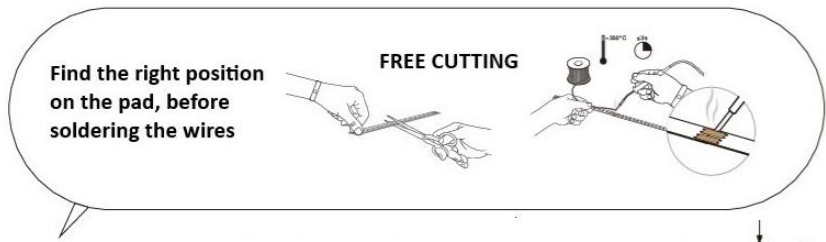



## LED STRIPS – 24V - LED 2835 – CRI90 – IP65 – K SERIE

### Energy labelling (EU 2019/2015) and Ecodesign (EU 2019/2020) regulations

Part Number	N° EPREL	EU 2019/2015 Energy rating	EU 2019/2020 Compliance
A41K24120A27 – 2700K	2601667	E	COMPLIANT
A41K24120A30 – 3000K	2601668	E	COMPLIANT
A41K24120A40 – 4000K	2601669	E	COMPLIANT
A41K24160A27 – 2700K	2601670	E	COMPLIANT
A41K24160A30 – 3000K	2601671	E	COMPLIANT
A41K24160A40 – 4000K	2601672	E	COMPLIANT
A41K24200A27 – 2700K	2601674	E	COMPLIANT
A41K24200A30 – 3000K	2601675	E	COMPLIANT
A41K24200A40 – 4000K	2601676	E	COMPLIANT
A41K24240A27 – 2700K	2601677	E	COMPLIANT
A41K24240A30 – 3000K	2601678	E	COMPLIANT
A41K24240A40 – 4000K	2601679	E	COMPLIANT

The scan of the QR Code on the energy label of the product refers directly to the description of the model in the EPREL (EU Product Database for Energy Labelling) database, where it is possible to download the energy labels and the information sheet of the product.

In alternative, it is possible to access the database using the model registration number (EPREL ID), which you can obtain from the product supplier.

Just insert in the browser the link <https://eprel.ec.europa.eu/screen/product/lightsources/> and add the EPREL ID after the last slash.

### Product weight / 5m reel

A41K24120Axx	210 gr.
A41K24160Axx	265 gr.
A41K24200Axx	305 gr.
A41K24240Axx	330 gr.

## Installation

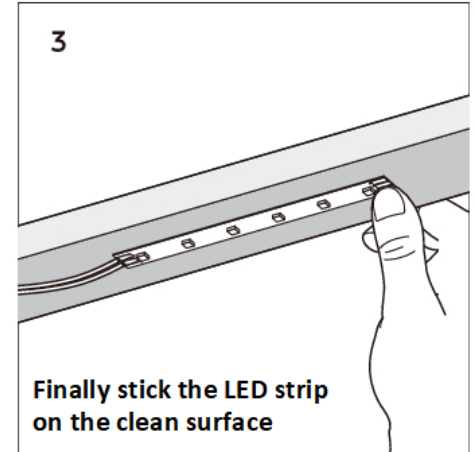
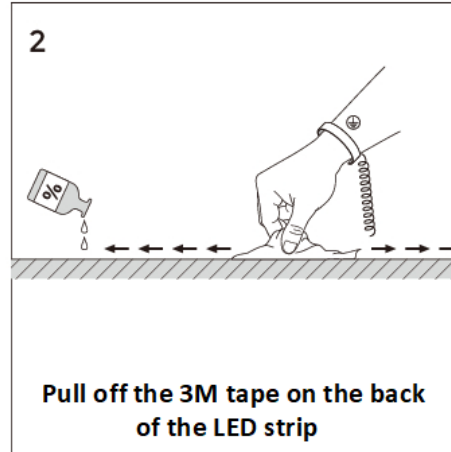
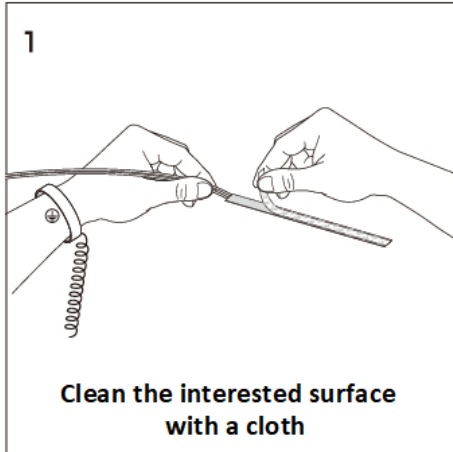

## Cutting

