



## Technical details

Product No.	A41N2414H0RG	A41N2414H1RG
Led Q.ty (LEDs/m)	144	144
Led Type	3838	3838
Power (W/M)	14	8
Voltage (V)	24 ±3%	24 ±3%
Current (mA/M)	583mA	333mA
Lenght/Reel (M)	5	10
Beam	120°	120°
Water-proof rating	IP67	IP67

<p>Non-directional or directional light source:</p> <p>Mains or non-mains light source:</p> <p>Dimmable:</p> <p>Cables type:</p> <p>Pcb material:</p> <p>Tape type:</p> <p>Protection against electric shock:</p> <p>Version:</p> <p>Safety isolating:</p> <p>Lumen maintenance factor:</p> <p>Survival factor:</p> <p>Nominal lifetime LM-80:</p> <p>Photobiological Safety (Blue light hazard) according to IEC TR 62778:</p>	<p>Non-directional (NDLS)</p> <p>Non-mains (NMLS)</p> <p>Only with specific LED drivers</p> <p>PVC 80°C 22AWG lenght 35cm (double ended)</p> <p>COPPER</p> <p>3M 9080</p> <p>Class III</p> <p>Integral</p> <p>See electronic controlgear</p> <p>96%</p> <p>100%</p> <p>L70 B50 &gt;54000 h</p> <p>Risk Exempt (RG0 group)</p>
---	---

## LED STRIPS – NEON RGB – IP67 OUTDOOR

### Lumens per meter

Color Temperature	A41N2414H0RG	A41N2414H1RG
RED	140 lm	75 lm
GREEN	205 lm	235 lm
BLUE	96 lm	50 lm
RGB	640 lm	360 lm

● Due to tolerances of the production process and the electrical components, values for light output and electrical power can vary up to 10%.

### Light distribution

LUMINOUS INTENSITY DISTRIBUTION DIAGRAM

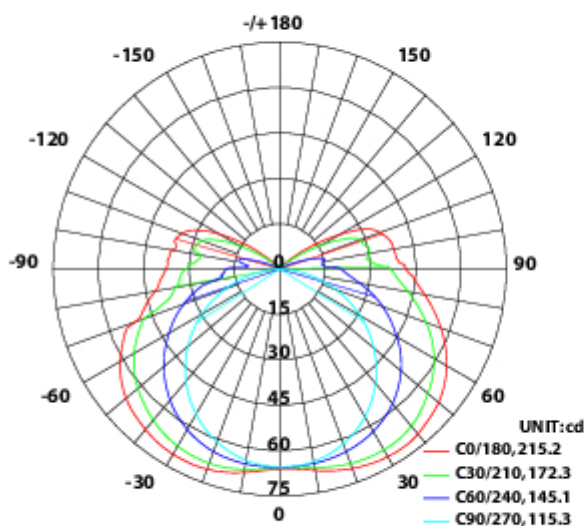

C0 PLANE ISOLUX DIAGRAM (UNIT:lx)

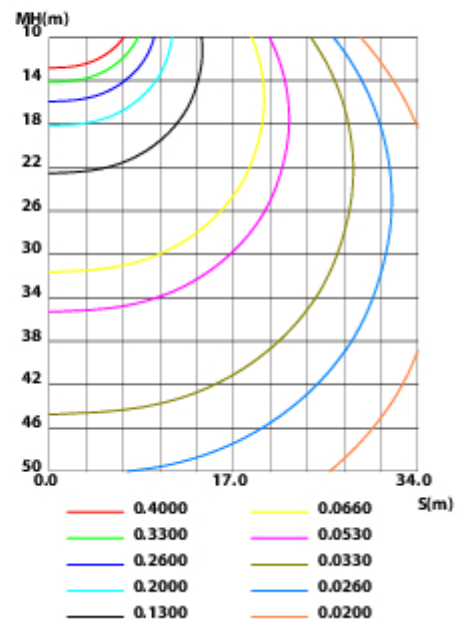

### Working conditions

Working Temperature (°C)	-20 ÷ 60
Storage Temperature (°C)	-30 ÷ 80
Voltage Range (Vdc)	23 ÷ 25
Reverse Voltage (Vdc)	25
Reference temperature (Tc)	80° C

# LED STRIPS – NEON RGB – IP67 OUTDOOR

## Product dimensions and cutting

### A41N2414H0RG

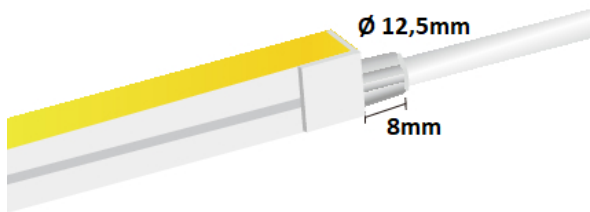
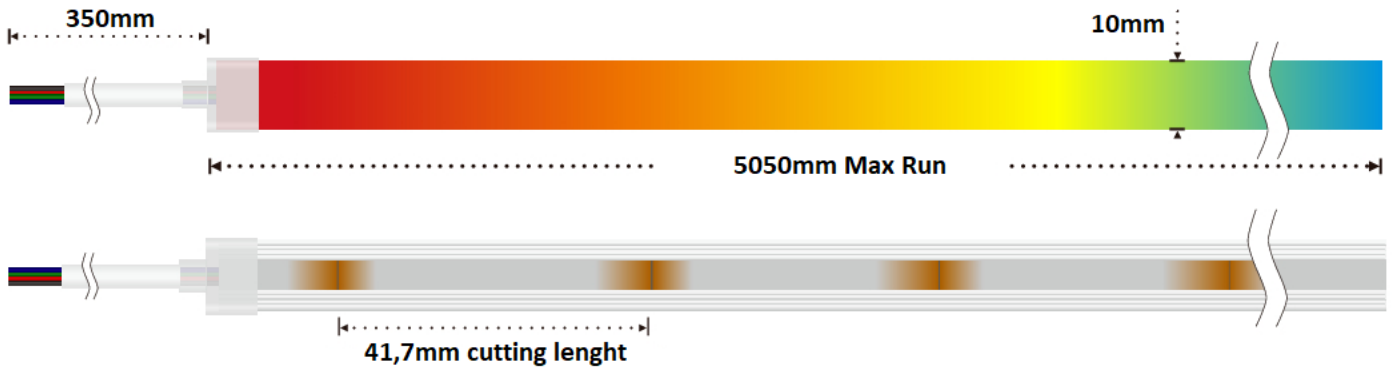
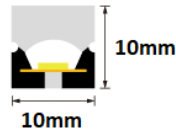

### A41N2414H1RG

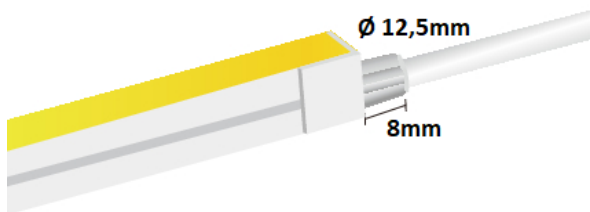
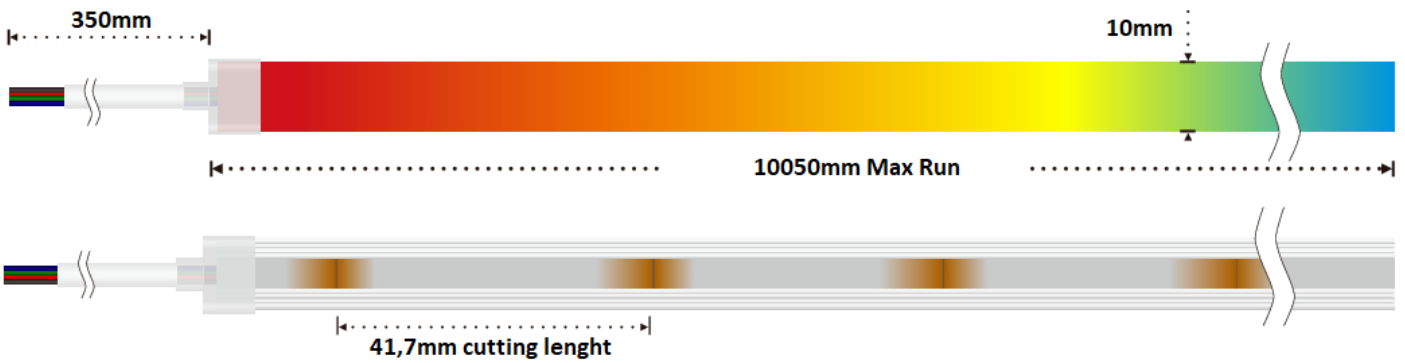
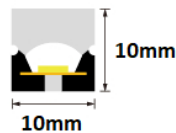

## Correct bending way

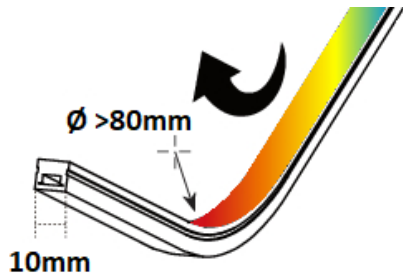





## Product weight per reel

A41N2414H0RG	820 gr.
A41N2414H1RG	1650 gr.

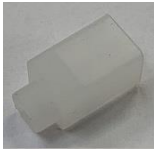
## Accessories

### 1-A41KITNRGOUT

	Front cap with hole (x 2)
	End cap without hole (x 4)
 5.1x9.4x20mm	Clip + screw (x 10)
	Glue + glue nozzle (x 2)

## Installation

### Cutting

- ① Cut the NEON strip at the required length

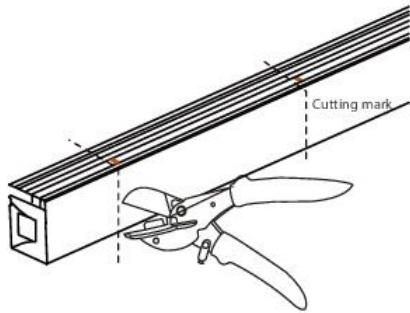

⚠ Cut at cutting mark only

- ② Cut the side of NEON strip exposing the soldering pad

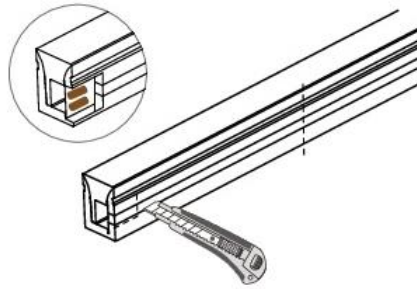

### Soldering

- ① Solder cable wires on pcb pads

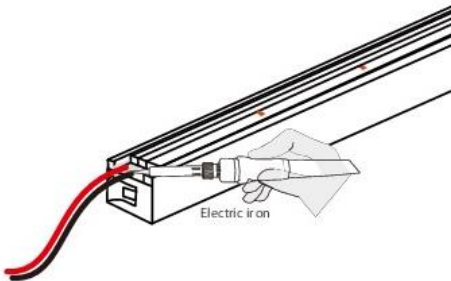

- ② Put the wire through the end cap and inject glue

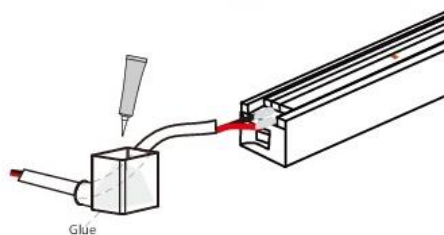

⚠ Optimum glue quantity between 1/3-1/2 of end cap capacity

### Installing end cap

- ① Push the end cap and wrap it around end of NEON strip

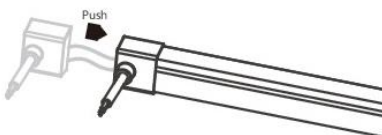

After the glue is injected, the NEON strip needs to be laid flat for 2 hours minimum before further processing

- ② Apply gel around the tail of NEON strip and install the end cap

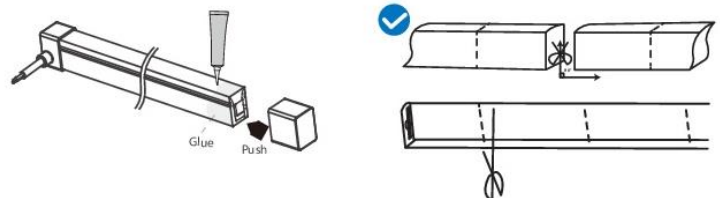

⚠ After the glue is injected, the NEON strip needs to be laid flat for 2 hours minimum before project process. Glue will be completely dry after 24 hours.

## Clip or aluminum profile

Fix the clips and the aluminum profile using the screws

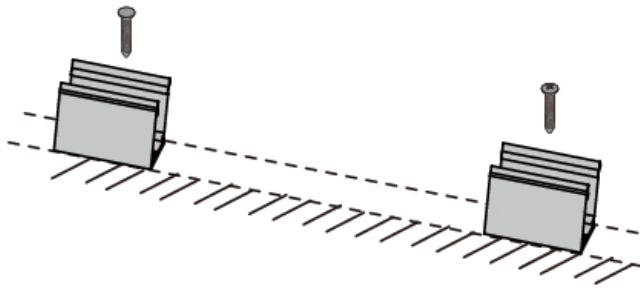

 Suggestion: 2 clips per meter

Simultaneously install the NEON strip from both ends

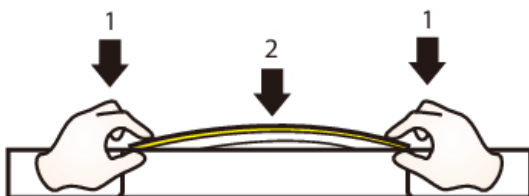

Use appropriate tools when removing the NEON strip

